



## Description

Pathfinder is an innovative bollard light which enhances the aesthetic and beauty of modern cityscapes. Its architectural design can meet the demands of different areas in squares, parks, gardens, sidewalks and others. The Pathfinder series blends a unique smile look with functionality and 4 options to illuminate walkways in urban and institutional settings. Its simple design and UV resistant PC material and IP65 rating will assure years of performance and visual comfort with a dark sky compliant design. A GFCI option is available for charging devices on the fly or powering other devices.

## Key Features

- IP65 and IK07
- Integrated with GFCI receptacle that has leak protection, convenient for outdoor operations power access
- Unique and gorgeous appearance
- Visor is available as accessory
- Professional Type V light distribution

## Applications

- Gardens
- Pathways
- Sidewalk
- Building entrance

## Electrical Information

<b>Model No.</b>	BL05-14	BL05-24
<b>Power Consumption (W)</b>	14	24
<b>Power Supply</b>	Becky	
<b>Input Voltage</b>	120-277 VAC, 50 / 60 Hz (Lamp body)	16A 125VAC, 60Hz (GFCI receptacle)
<b>Power Factor</b>	>0.9	
<b>Surge Protection</b>	2kV line-line, 4kV line-earth	
<b>Driver Type</b>	Constant current (CC)	
<b>Control</b>	0-10V dimmable	
<b>Note</b>	NA	

\* The tolerance for power is ±5%.

## Optic Information

<b>LED Type</b>	LED 3030	
<b>Luminous Flux (lm)</b>	1680	2520
<b>Efficacy (lm/W)</b>	120lm/W(R03203)	105lm/W(R03203)
<b>Correlated Color Temperature</b>	4000K (3000K, 5000K optional)	
<b>Color Rendering Index</b>	Ra70 (Ra80 optional)	
<b>Beam Angle</b>	R03203 (Type V)	
<b>UGR level</b>	NA	

\* The tolerance for luminous flux is ±10%.

## Dimensions and Mount

<b>Product Dimension (mm/inch)</b>	φ165×900 (φ6.5"×35.43")	φ165×1067 (φ6.5"×42")	φ165×900 (φ6.5"×35.43")	φ165×1067 (φ6.5"×42")
<b>Luminaire Net Weight (kg/lbs) (All-in-one package)</b>	7.1 (15.65)	7.8 (17.19)	7.1 (15.65)	7.8 (17.19)
<b>Export Carton Size (mm/inch) (All-in-one package)</b>	1065x210x215 (41.93"×8.27"×8.46")	1230x210x215 (48.43"×8.27"×8.46")	1065x210x215 (41.93"×8.27"×8.46")	1230x210x215 (48.43"×8.27"×8.46")
<b>Gross Weight (kg/lbs) (All-in-one package)</b>	8.1 (17.85)	8.7 (19.18)	8.1 (17.85)	8.7 (19.18)
<b>Export Carton Size (mm/inch) (Separated package)</b>	Lamp body: 360 x 210 x215 (14.17"×8.27"×8.46") Lamp 35.43 inch: 915x210x215 (36.02"×8.27"×8.46") Lamp 42 inch: 1075x210x215 (42.32"×8.27"×8.46")			
<b>Luminaire Net Weight (kg/lbs) (Separated package)</b>	Lamp body: 2.2 (4.85) Lamp 35.43 inch: 4.9 (10.8) Lamp 42 inch: 5.57 (12.28)			
<b>Gross Weight (kg/lbs) (Separated package)</b>	Lamp body: 2.66 (5.86) Lamp 35.43 inch: 5.8 (12.78) Lamp 42 inch: 6.2 (13.66)			
<b>Mounting Option</b>	Mounting kit with anchor bolts			
<b>Material</b>	Aluminum alloy Polycarbonate optical lens			
<b>Finish</b>	Powder coating			
<b>Fixture Color</b>	Black (RAL 9017) /Brown(RAL8019)			
<b>EPA</b>	NA			
<b>IK Rating</b>	IK07			
<b>IP Rating</b>	IP65			
<b>Category of corrosion</b>	C3 (ISO 9223:2012)			

\* The tolerance for weight is ±6%.

## Lifespan and Warranty

<b>Operating Temperature (°C)</b>	-30 to +50 (-22°F to 122°F)
<b>Lifespan of LED @Ta=25°C (hours)</b>	L90-37800 L80-78500 L70-124600
<b>Warranty (years)</b>	5

## New Features

- 10KV SPD available (optional)

\* Please consult us for details.

## Photometry

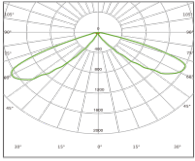

A03203 (Type V)

## Mounting Options

Mounting kit with anchor bolts

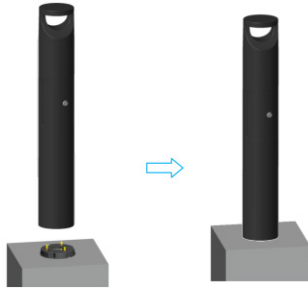

## Dimensions

Unit:mm

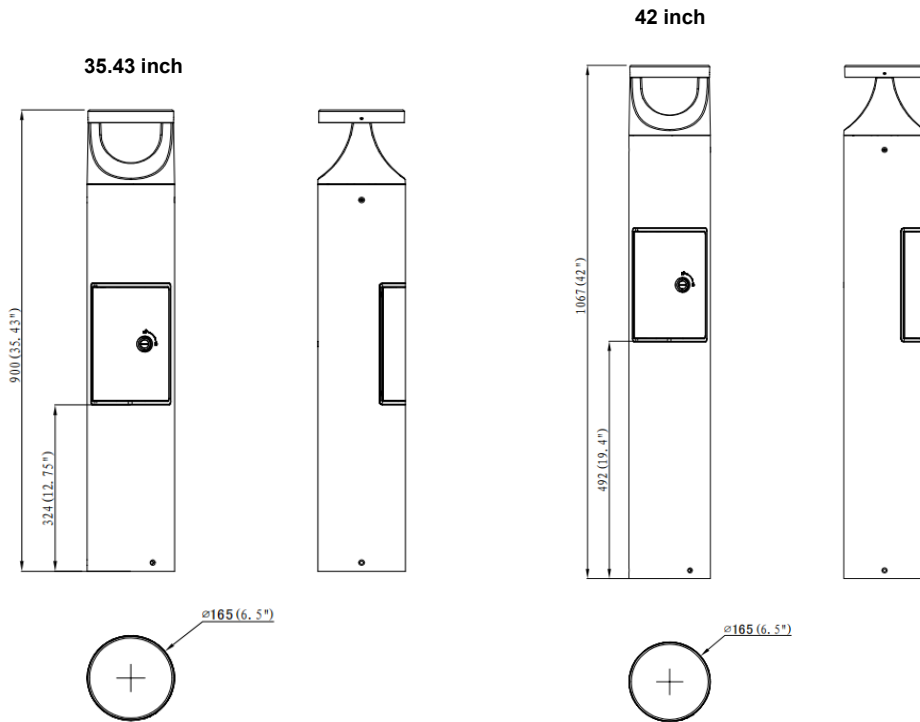

## Accessories



**Round House Side Shield**  
To reduce glare light



**Backfilled Anchor**  
Q235 +SPCC, hot dip galvanizing  
 $\Phi 130 \times 508 \text{mm}$ .